

REAR DIFFERENTIAL

LIMITED SLIP DIFFERENTIAL DISASSEMBLY

- Disassemble in the order indicated in the table.

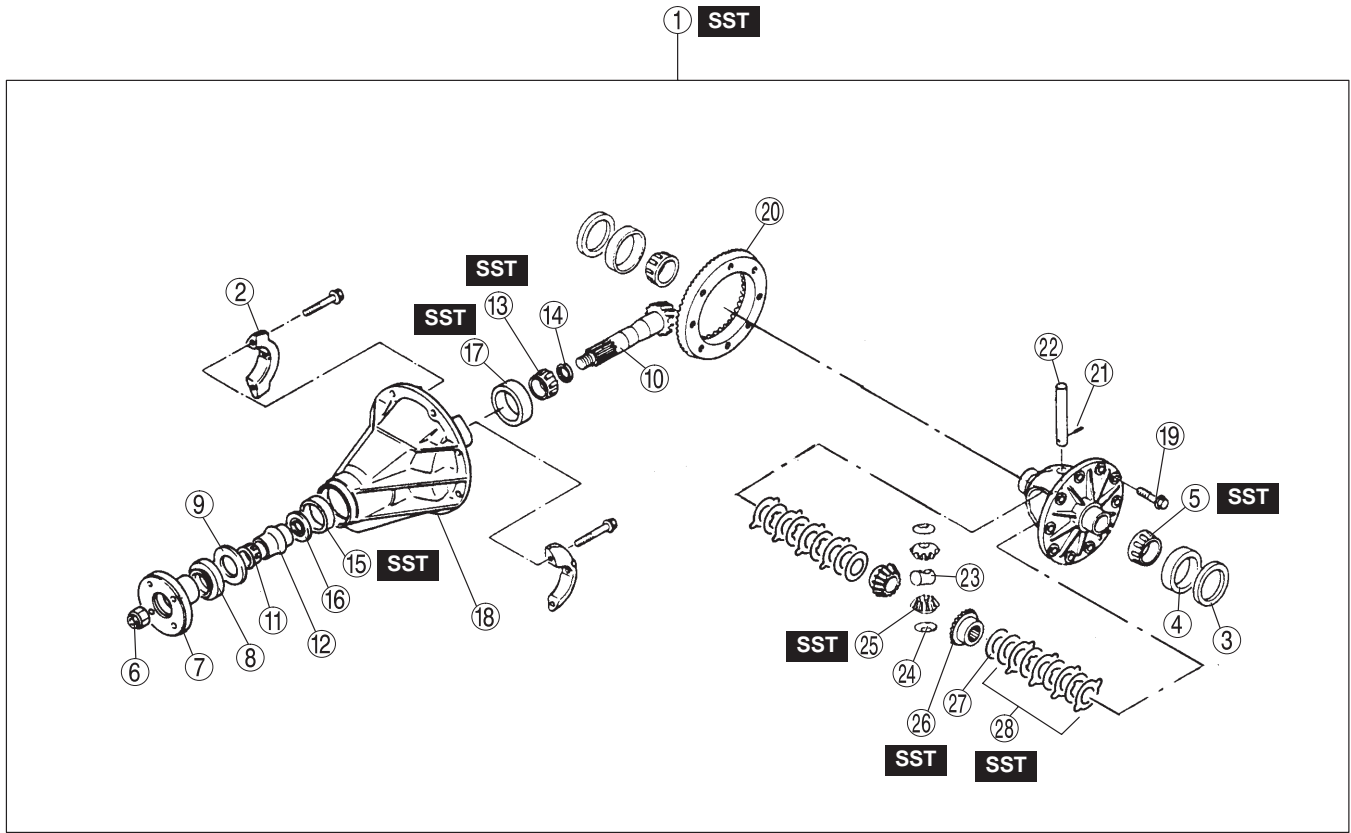

1	Differential component + REAR DIFFERENTIAL, STANDARD DIFFERENTIAL DISASSEMBLY, Differential Component Disassembly
2	Bearing cap + REAR DIFFERENTIAL, STANDARD DIFFERENTIAL DISASSEMBLY, Bearing Cap Disassembly Note
3	Adjusting shim
4	Side bearing cup
5	Side bearing cone + REAR DIFFERENTIAL, STANDARD DIFFERENTIAL DISASSEMBLY, Side Bearing cone Disassembly Note
6	Pinion nut + REAR DIFFERENTIAL, STANDARD DIFFERENTIAL DISASSEMBLY, Pinion nut Disassembly Note
7	Companion frange + REAR DIFFERENTIAL, STANDARD DIFFERENTIAL DISASSEMBLY, Companion Frang Disassembly Note

8	Oil seal + REAR DIFFERENTIAL, STANDARD DIFFERENTIAL DISASSEMBLY, Oil Seal Disassembly Note
9	Thrust washer
10	Drive pinion + REAR DIFFERENTIAL, STANDARD DIFFERENTIAL DISASSEMBLY, Drive Pinion Disassembly Note
11	Front bearing cone
12	Collapsible spacer
13	Rear bearing cone + REAR DIFFERENTIAL, STANDARD DIFFERENTIAL DISASSEMBLY, Rear Bearing Inner Race Disassembly Note
14	Adjusting shim
15	Front bearing cup + REAR DIFFERENTIAL, STANDARD DIFFERENTIAL DISASSEMBLY, Front Bearing cup Disassembly Note
16	Oil baffle

REAR DIFFERENTIAL

17	Rear bearing cup + REAR DIFFERENTIAL, STANDARD DIFFERENTIAL DISASSEMBLY, Rear Bearing cup Disassembly Note
18	Carrier
19	Hex screw
20	Ring gear
21	Roll pin + REAR DIFFERENTIAL, STANDARD DIFFERENTIAL DISASSEMBLY, Roll Pin Disassembly Note
22	Pinion shaft
23	Thrust block
24	Pinion gear thrust washer
25	Pinion gear
26	Side gear
27	Side gear thrust washer
28	Limited slip differential component + Disassembly Note

Limited Slip Differential Component Disassembly Note

- Place one of the axle shafts, which was removed from the component, into a vise, with the splines extending above the jaws of the vise far enough to engage the side gears of the differential case component, and position the differential case onto the axle shaft as a holding fixture by aligning the splines of the side gear with those of the axle shaft.

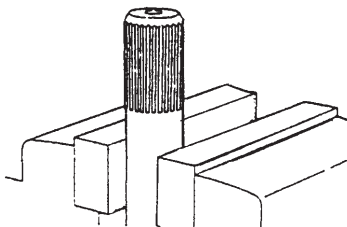

- Install the **SST** into the bottom of the side gear, and apply grease to the centering hole of it.

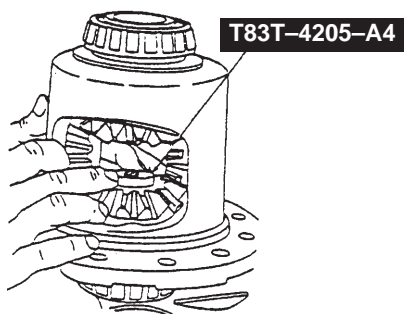

- Install the **SSTs** into the differential case.

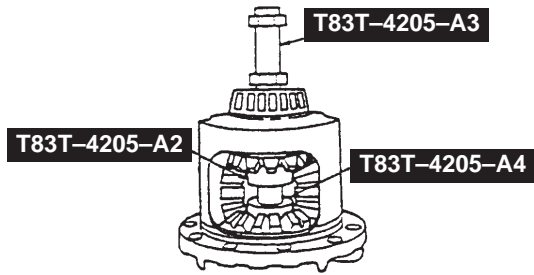

- Tighten the **SST** to move the side gears away from the pinion gears and relieve the normal loaded condition.

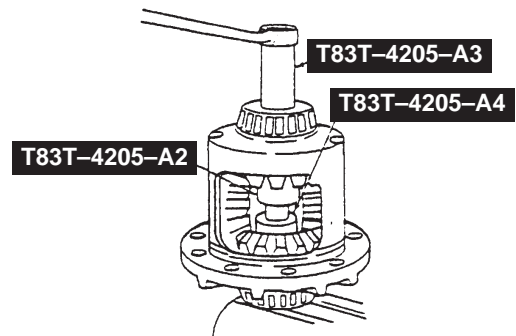

- Push out the thrust washers located behind the pinion gears.
- Momentarily, loosen the **SST**. Retighten the **SST** until a very slight movement of the pinion gears is seen.
- Insert **SST** into the bore of the pinion shaft and rotate the differential case until the pinion gears can be removed through the large openings in the differential case.

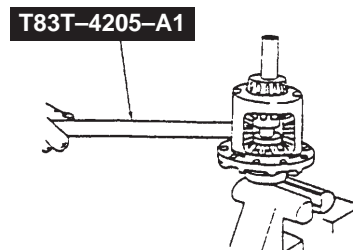

- Retain the top side gear and clutch pack in the differential case by hand and remove the **SSTs**.

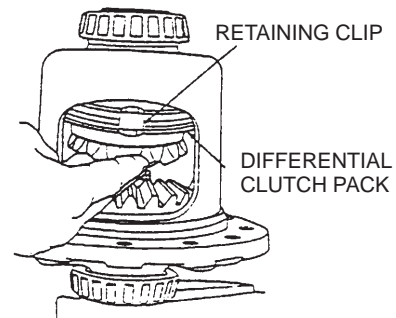

- Remove the top side gear and clutch pack. Keep the stack of clutch plates and clutch discs in exact order.
- Remove the retainer clips from both clutch packs to allow separation of the clutch discs and clutch plates for cleaning and inspection.