

FRONT DIFFERENTIAL

FRONT DIFFERENTIAL REMOVAL/INSTALLATION

1. Drain the differential oil. (Refer to FRONT DIFFERENTIAL, FRONT DIFFERENTIAL OIL REPLACEMENT.)
2. Remove the propeller shaft. (Refer to section L, FRONT PROPELLER SHAFT (4 × 4), FRONT PROPELLER SHAFT REMOVAL/INSTALLATION.)
3. Remove in the order indicated in the table.
4. Install in the reverse order of removal.

MFW

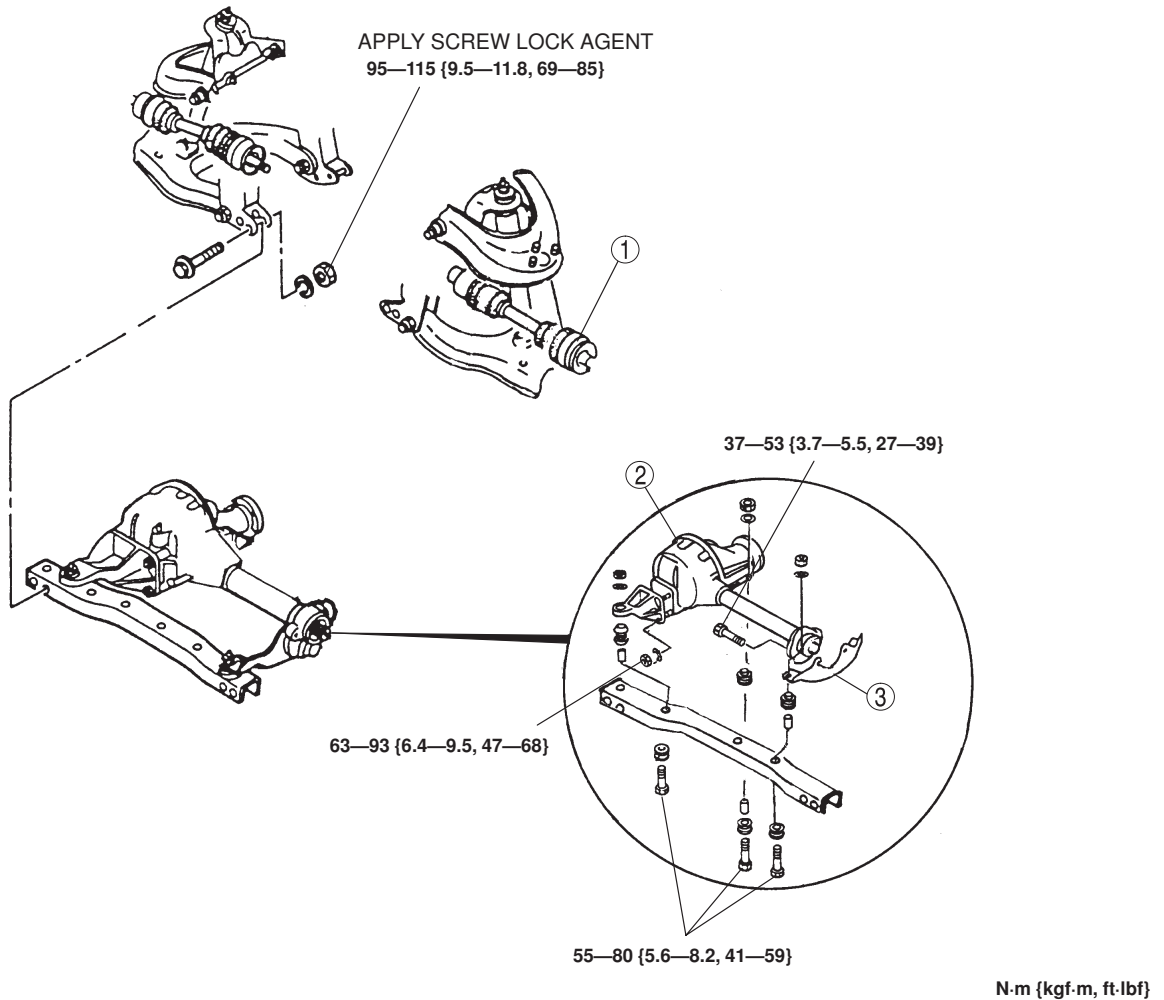

1	Drive shaft + DRIVE SHAFT, DRIVE SHAFT REMOVAL/ INSTALLATION, Drive Shaft Removal Note
---	--

2	Front differential component + Removal Note
3	Differential bracket

FRONT DIFFERENTIAL

RFW

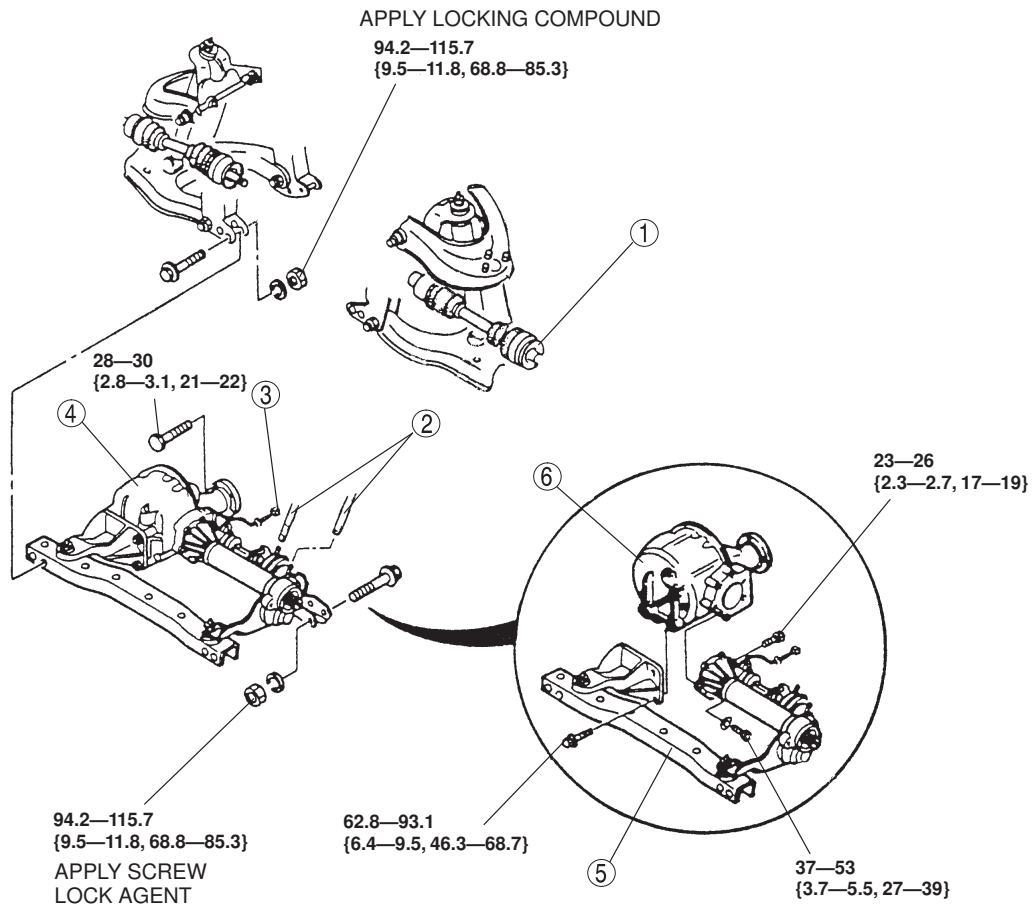

N·m {kgf·m, ft·lbf}

1	Drive shaft + DRIVE SHAFT, DRIVE SHAFT REMOVAL/ INSTALLATION, Drive Shaft Removal Note
2	Vacuum hose
3	RFW switch component

4	Front differential, joint shaft component + Removal Note
5	Joint shaft, crossmember
6	Front differential

Front Differential, Joint Shaft Component Removal Note

1. Set the transmission jack on the differential.
2. Remove the bolts and nuts indicated by arrows.

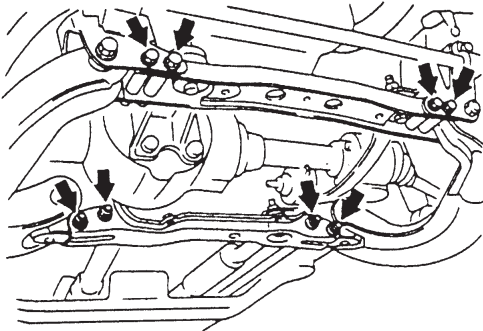

3. Remove the front differential and joint shaft component from the vehicle using the transmission jack.

