

14-1. GENERAL DESCRIPTION

The transfer gear box is an auxiliary transmission for on-off control of two-speed drive transmitted to both front and rear axles concurrently and provides additional speed reductions, HIGH and LOW, for any selection of main transmission gears.

The functions of this auxiliary transmission are mainly two-selection between four-wheel drive (front and rear axles) and two-wheel drive (rear axle) and between HIGH and LOW for four-wheel drive. Three propeller shafts are associated with the gear box.

These functions are accomplished by means of four shafts arranged in three-axis configuration and two sliding clutches. The selection is effected by actuating these clutches from a single control lever located beside the driver's seat. The gear box is mounted on a chassis frame.

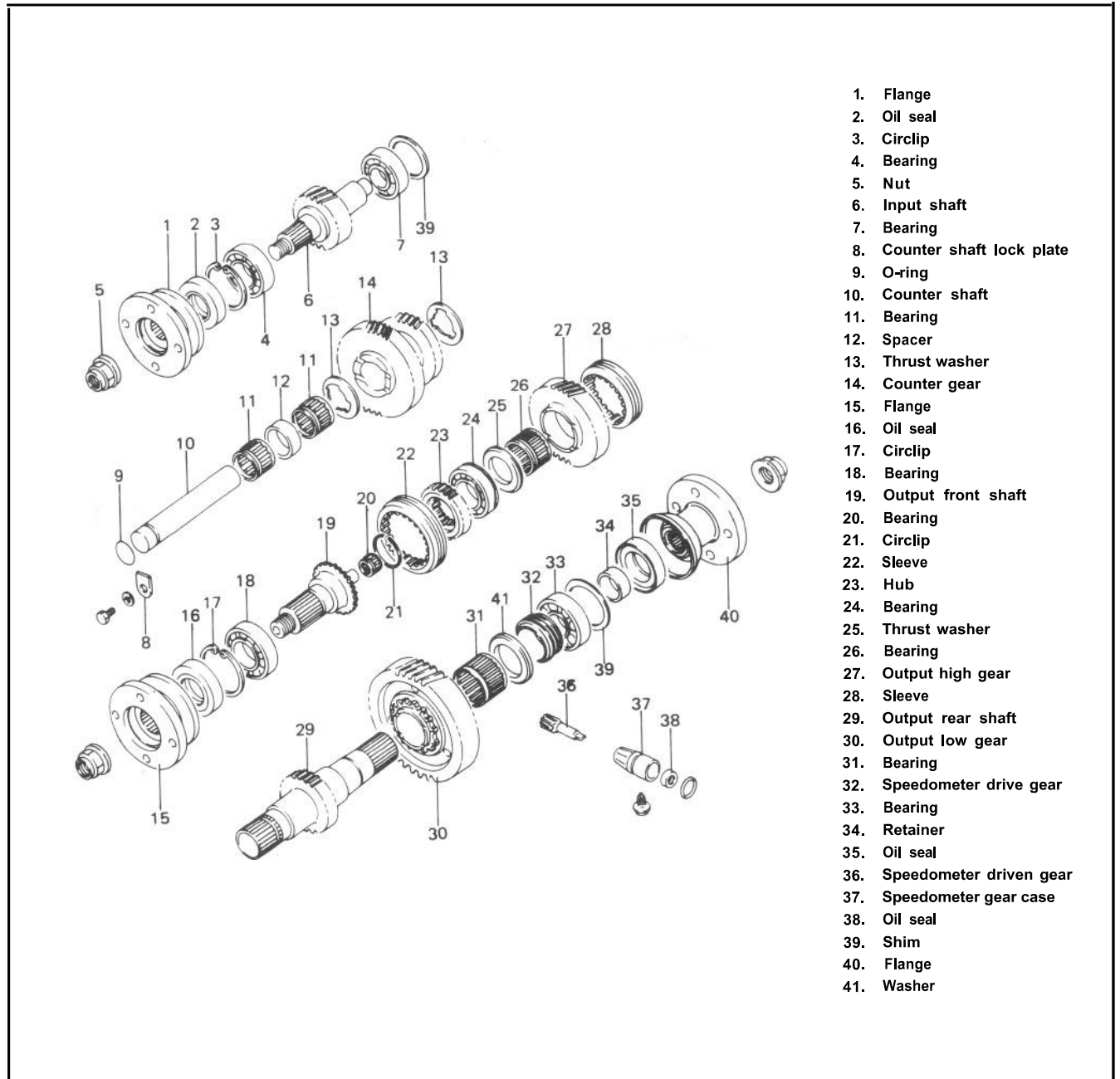

Fig. 14-1