

AIR BAG SYSTEM

- For vehicles with a single point sensor, once an air bag is deployed due to an accident or other causes, the SAS unit must be replaced with a new one even if the used one does not have any external signs of damage. The used SAS unit may have been damaged internally which may cause improper operation, resulting in major injuries or even death. The used single point SAS unit cannot be bench-checked or self-checked.

Component Handling

- Oil, grease, water, etc., on components may cause an air bag module to fail to deploy in an accident, which may cause serious injury. Do not allow oil, grease, water, etc., on components.
- Inserting a screwdriver, etc., into the connector of an air bag module may damage the connector and cause the air bag module to deploy improperly, which may cause serious injury. Do not insert any foreign objects into the connector.

Component Reusing

- Even if an air bag module does not deploy in a collision and does not have any external signs of damage, it may have been damaged internally, which may cause improper operation. Improper operation may cause serious injury. Always self-check the undamaged air bag module to determine whether it can be reused. (Refer to ON-BOARD DIAGNOSTIC FUNCTION, AIR BAG SYSTEM.)

DRIVER-SIDE AIR BAG MODULE REMOVAL/INSTALLATION

Warning

- Handling the air bag module improperly can accidentally deploy the air bag module, which may seriously injure you. Read **SERVICE WARNINGS** before handling the air bag module. (Refer to **SERVICE WARNINGS**.)

- Turn the ignition switch to LOCK position.
- Disconnect the negative battery cable and wait for **more than 1 minute**.
- Remove in the order indicated in the table.
- Install in the reverse order of removal.
- Turn the ignition switch to ON position.
- Verify that the air bag system warning light illuminates for **approximately 6 seconds** then goes off.
- If the air bag system warning light remains on, off, or repeats flashing after servicing, there are malfunctions in the system. Perform the inspection again. (Refer to ON-BOARD DIAGNOSTIC FUNCTION, AIR BAG SYSTEM.)

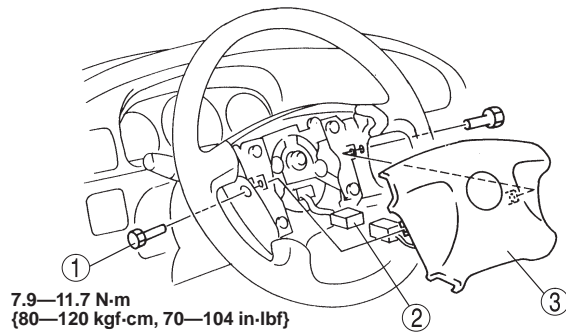

| | |
|---|----------------------------------|
| 1 | Bolt + Installation Note |
| 2 | Connector + Installation Note |
| 3 | Driver-side air bag module |

Connector Installation Note

- Install the connector as shown in the figure.

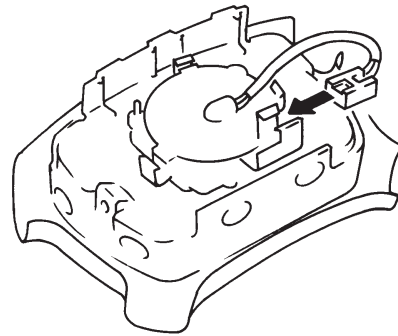

Bolt Installation Note

- Tighten the bolts in the order shown in the figure.

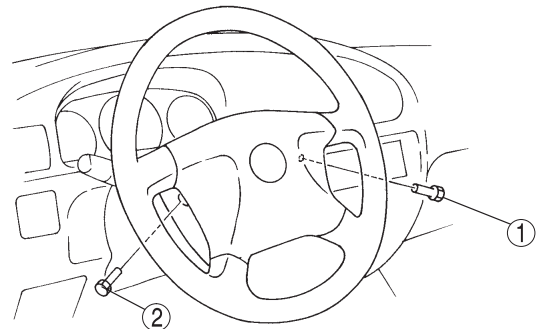

PASSENGER-SIDE AIR BAG MODULE REMOVAL/INSTALLATION

Warning

- Handling the air bag module improperly can accidentally deploy the air bag module, which may seriously injure you. Read **SERVICE WARNINGS** before handling the air bag module. (Refer to **SERVICE WARNINGS**.)

- Turn the ignition switch to LOCK position.
- Disconnect the negative battery cable and wait for **more than 1 minute**.
- Remove the glove compartment.
- Remove in the order indicated in the table.

AIR BAG SYSTEM

5. Install in the reverse order of removal.
6. Turn the ignition switch to ON position.
7. Verify that the air bag system warning light illuminates for **approximately 6 seconds** then goes off.
8. If the air bag system warning light remains on, off, or repeats flashing after servicing, there are malfunctions in the system. Perform the inspection again. (Refer to ON-BOARD DIAGNOSTIC FUNCTION, AIR BAG SYSTEM.)

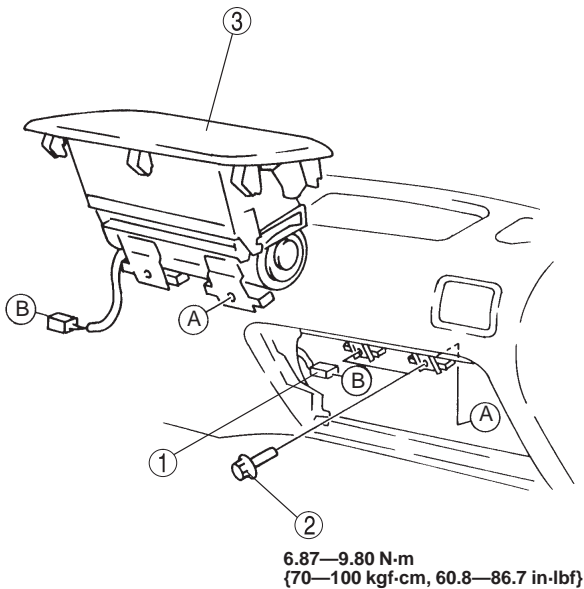

| | |
|---|-------------------------------|
| 1 | Connector |
| 2 | Bolt |
| 3 | Passenger-side air bag module |

SAS UNIT REMOVAL/INSTALLATION

Warning

- Handling the SAS unit improperly can accidentally deploy the air bag module, which may seriously injure you. Read **SERVICE WARNINGS** before handling the SAS unit. (Refer to **SERVICE WARNINGS**.)

1. Turn the ignition switch to LOCK position.
2. Disconnect the negative battery cable and wait for **more than 1 minute**.
3. Remove the front console. (Refer to section S, DASHBOARD AND CONSOLE, FRONT CONSOLE REMOVAL/INSTALLATION.)
4. Remove in the order indicated in the table.
5. Install in the reverse order of removal.
6. Turn the ignition switch to ON position.
7. Verify that the air bag system warning light illuminates for **approximately 6 seconds** then goes off.

Note

- When a new SAS unit has been installed, the air bag system warning light flashes continuously if there aren't any malfunctions in the system. Perform the air bag module deployment authorization procedure. (Refer to AIR BAG MODULE DEPLOYMENT AUTHORIZATION PROCEDURE.)

8. If the air bag system warning light remains on, off, or repeats flashing after servicing, there are malfunctions in the system. Perform the inspection again. (Refer to ON-BOARD DIAGNOSTIC FUNCTION, AIR BAG SYSTEM.)

6.87—9.80 N·m
{70—100 kgf·cm, 60.8—86.7 in·lbf}

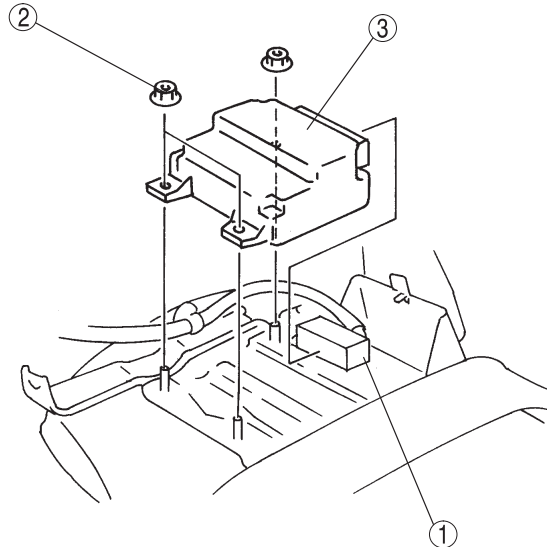

| | |
|---|----------------------------|
| 1 | Connector |
| 2 | Nut + Installation Note |
| 3 | SAS unit |

Nut Installation Note

- Tighten the nuts in the order shown in the figure.

