

# AIR BAG SYSTEM

5. Install in the reverse order of removal.
6. Turn the ignition switch to ON position.
7. Verify that the air bag system warning light illuminates for **approximately 6 seconds** then goes off.
8. If the air bag system warning light remains on, off, or repeats flashing after servicing, there are malfunctions in the system. Perform the inspection again. (Refer to ON-BOARD DIAGNOSTIC FUNCTION, AIR BAG SYSTEM.)

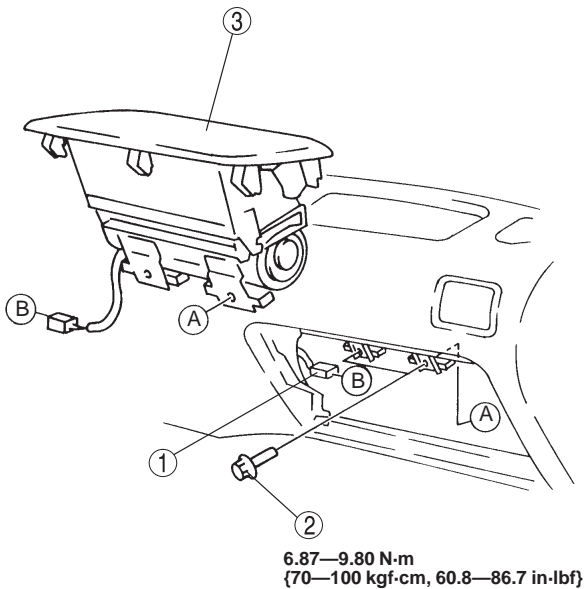

1	Connector
2	Bolt
3	Passenger-side air bag module

## SAS UNIT REMOVAL/INSTALLATION

### Warning

- **Handling the SAS unit improperly can accidentally deploy the air bag module, which may seriously injure you. Read SERVICE WARNINGS before handling the SAS unit. (Refer to SERVICE WARNINGS.)**

1. Turn the ignition switch to LOCK position.
2. Disconnect the negative battery cable and wait for **more than 1 minute**.
3. Remove the front console. (Refer to section S, DASHBOARD AND CONSOLE, FRONT CONSOLE REMOVAL/INSTALLATION.)
4. Remove in the order indicated in the table.
5. Install in the reverse order of removal.
6. Turn the ignition switch to ON position.
7. Verify that the air bag system warning light illuminates for **approximately 6 seconds** then goes off.

### Note

- When a new SAS unit has been installed, the air bag system warning light flashes continuously if there aren't any malfunctions in the system. Perform the air bag module deployment authorization procedure. (Refer to AIR BAG MODULE DEPLOYMENT AUTHORIZATION PROCEDURE.)

8. If the air bag system warning light remains on, off, or repeats flashing after servicing, there are malfunctions in the system. Perform the inspection again. (Refer to ON-BOARD DIAGNOSTIC FUNCTION, AIR BAG SYSTEM.)

6.87—9.80 N·m  
{70—100 kgf·cm, 60.8—86.7 in·lbf}

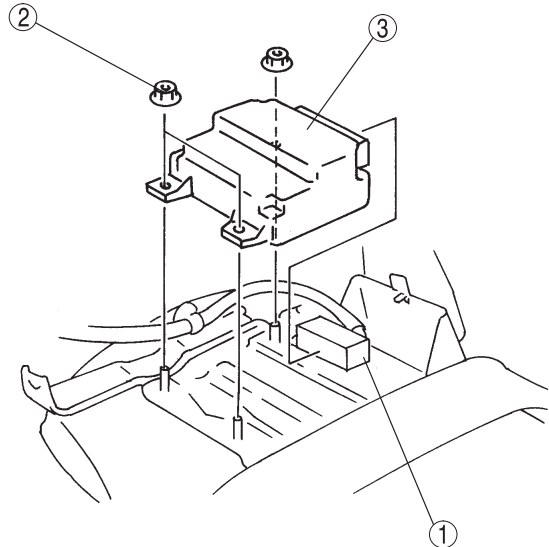

1	Connector
2	Nut + Installation Note
3	SAS unit

### Nut Installation Note

- Tighten the nuts in the order shown in the figure.

