

### EVAPORATOR INSPECTION

1. Remove the cooling unit. (Refer to COOLING UNIT REMOVAL/INSTALLATION.)
2. Remove the evaporator from the cooling unit.
3. Inspect for cracks, damage, and oil leakage. If any problems are found, replace the evaporator.
4. Inspect for bent fins. If they are bent, use a flat-head screwdriver to straighten them.

### HEATER UNIT REMOVAL/INSTALLATION

1. Disconnect the negative battery cable.
2. Drain the engine coolant. (Refer to section E, ENGINE COOLANT, ENGINE COOLANT REPLACEMENT.) (With heater core only)
3. Remove the dashboard. (Refer to section S, DASHBOARD AND CONSOLE, DASH BOARD REMOVAL/INSTALLATION.)
4. Remove in the order indicated in the table.
5. Install in the reverse order of removal.

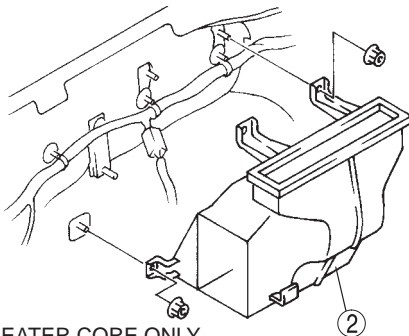
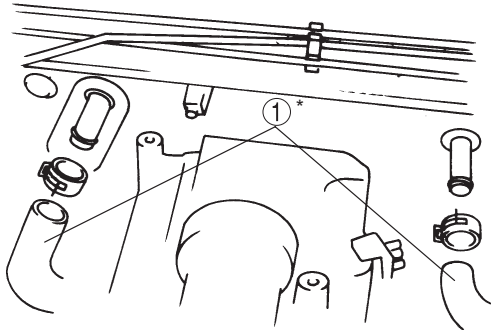

\* WITH HEATER CORE ONLY

1	Heater hose
2	Heater unit